

SKF QuickCollect sensor

Machine monitoring made easy



SKF QuickCollect sensor

The SKF QuickCollect sensor is an easy to use bluetooth enabled handheld sensor that connects to iOS and Android apps on your tablet, smart phone or smart watch (iOS only). Combining vibration and temperature sensing, overall data can be viewed on the spot in real time or pushed to the cloud for future analysis.

This SKF QuickCollect sensor is ideal for service, reliability, operations, or maintenance personnel as part of a walk around data collection program.

Features

- Velocity, acceleration enveloping, and temperature measurements
- Bluetooth communication with tablets, smart phones, smart watches
- Easy to use sensor and apps
- Easy to understand indications of machine condition
- Rugged industrial design – Drop test 1,8 m (6 ft.), water and dust resistant (IP65)
- Rechargeable lithium battery (8 hours normal usage)
- Option to connect, store and share data on the Cloud
- Option to connect directly to SKF Remote Diagnostic Services
- Apps for both iOS and Android devices

Benefits

- Gets you started quickly
- Can be used with minimum training and experience
- Identify developing rotating machinery issues before they become problems
- Connect directly to expert advice when you need it
- Expand functionality via apps to grow and compliment your existing maintenance program

Controls and indicators

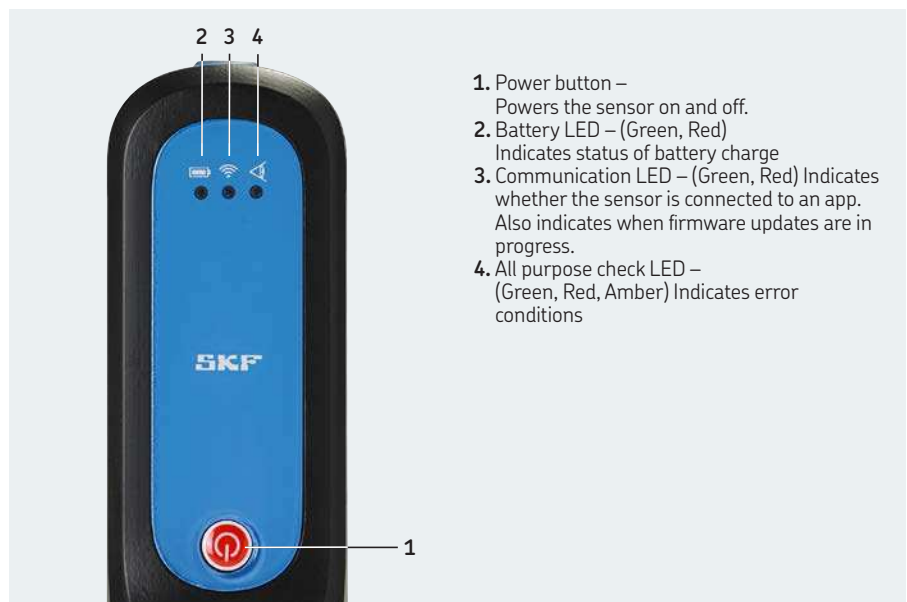

Measurement displays

Measurements taken by the sensor are shown on your mobile device, which displays velocity, acceleration, and temperature as shown below:

Each reading displays a current overall measurement, including alarm status, minimum and maximum values, and alert and danger thresholds.

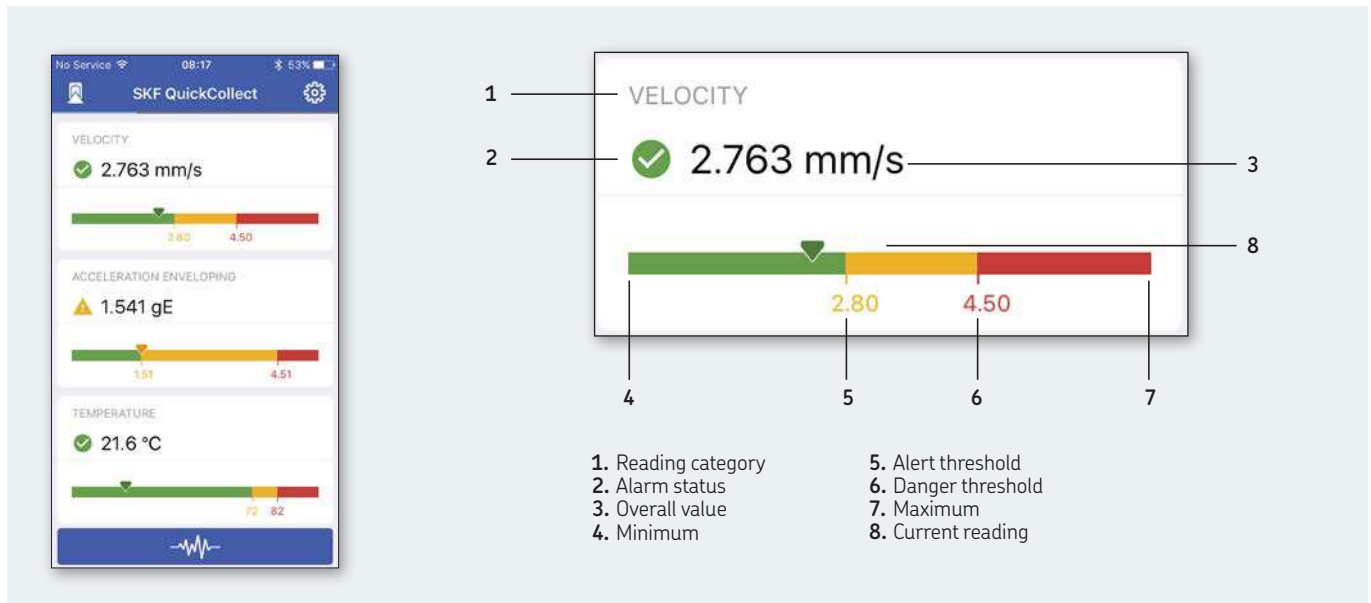

SKF Enlight QuickCollect System

The SKF QuickCollect sensor can be used with the SKF QuickCollect app, or with SKF DataCollect app which provides additional functionality, including the ability to store

and share data via the SKF cloud, and to directly access SKF Remote Diagnostic Services.

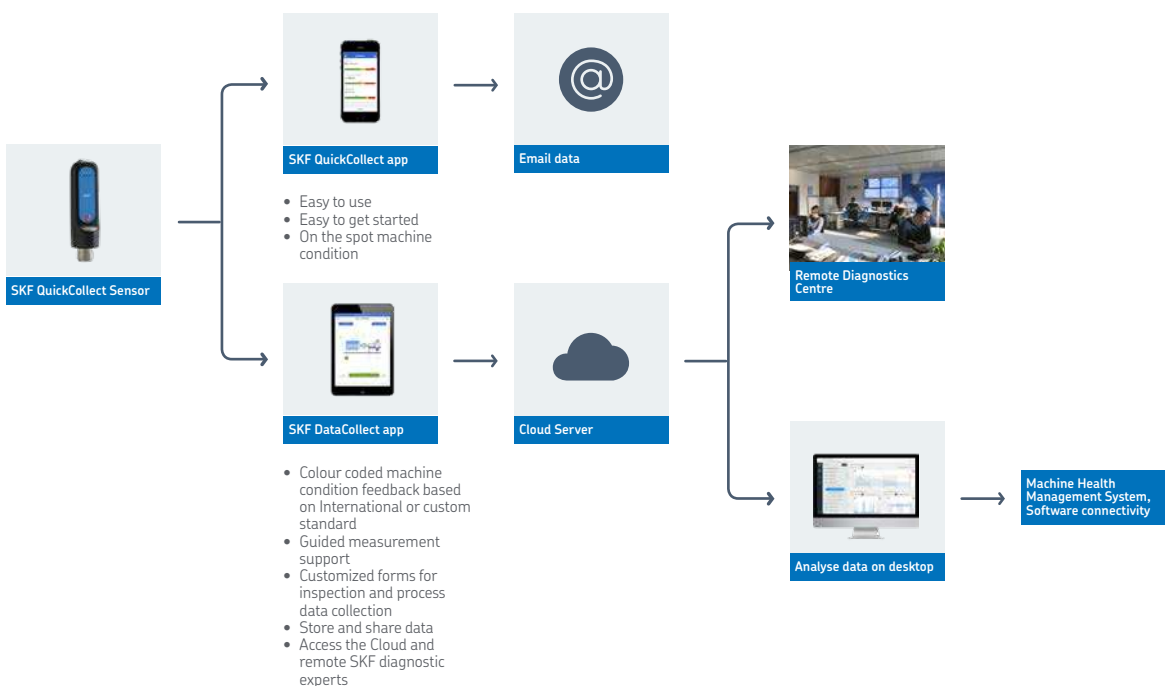

Technical specifications

Environmental and regulatory specifications

Temperature range	Non-hazardous areas: -20 to +60 °C Hazardous areas: -20 to +60 °C Charging: 0 to +40 °C
Humidity	95% non-condensing
IP rating	IP 65, Dust and water ingress protection testing standard.
Radio Approvals	Europe (CE), USA (FCC), Canada (IC)
CE Mark	CE approved

Measurement range

Overalls	
Velocity:	10 Hz to 1 kHz up to 55 mm/s
Bearing condition:	SKF patented Envelope acceleration up to 20 gE
FFT	
Maximum Frequency:	Velocity 1 kHz, Enveloped Acceleration 2 kHz
Lines of resolution:	Velocity 400, Enveloped acceleration 800
Detection type:	Velocity RMS, Enveloped acceleration True Peak to Peak
Temperature:	Capable of measuring outwith standard temperature range up to 100 °C for short periods

Power

Main Power	Rechargeable lithium battery, 3,7V DC, 0,14 A
Battery Lifetime	Eight hours with normal usage
MAINS supply voltage, charger	Varies up to ±10% of the nominal voltage TRANSIENT OVERVOLTAGE CATEGORY II; POLLUTION DEGREE 2
Charger	Input 5 V DC ± 10%, 1 A
AC Adapter	Input 100 to 240 V DC, 0,4 A, 47 to 63 Hz Output 5 V DC, 1,6 A

Environmental

Storage Temperature	-20 to +45 °C (-5 to +115 °F) for less than one month -20 to +35 °C (-5 to +95 °F) for less than six months
Operating Temperature, Battery	0 to +40 °C (32 to +105 °F) for charging -20 to +60 °C (-5 to +140 °F) for discharging
Operating Temperature, Charger	0 to +40 °C (32 to +105 °F)
Altitude	Up to 2 000 m (6 560 ft.)
Humidity	95% non-condensing

Physical

Case	Water and dust resistant (IP65)
Drop test	1,8 m (6ft) in accordance with MIL-STD-810G
Dimensions	45 x 45 x 135 mm (1.8 x 1.8 x 5.3 in.)
Weight	200 g (7 oz.)

Ordering Information

SKF QuickCollect kit CMDT 390-K-SL includes:
QuickCollect sensor [CMDT 390]
Charger, international DC power supply [CMAC 8004]
Magnet [CMAC 8009]
Quick Start user guide
Calibration certificate

Optional Accessories

Carry case [CMAC 8011]



skf.com | skf.com/cm

© SKF is a registered trademark of the SKF Group.

© SKF Group 2019
The contents of this publication are the copyright of the publisher and may not be reproduced (even extracts) unless prior written permission is granted. Every care has been taken to ensure the accuracy of the information contained in this publication but no liability can be accepted for any loss or damage whether direct, indirect or consequential arising out of the use of the information contained herein.

PUB CM/P2 17198 EN · February 2019