

Analog ultrasonic sensor

For lubricant reservoirs bigger than five litre

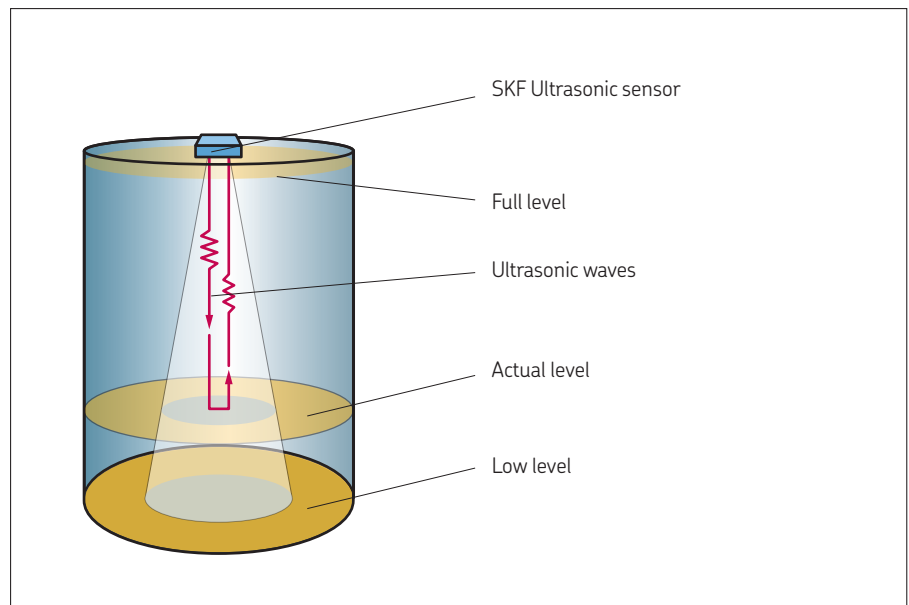

The SKF Ultrasonic sensor was developed to improve fill-level monitoring on SKF- and Lincoln-branded pumps and reservoirs with lubricant capacities in excess of five litre. Suitable for oil and grease applications, the sensor provides continuous level messages for optimum operation. Maintaining the appropriate amount of lubricant in the reservoir helps to avoid under-lubrication and possible equipment damage, while preventing overflow reduces waste and protects the environment. The SKF Ultrasonic sensor also improves the reliability of monitoring the pump function.

The SKF Ultrasonic sensor is suitable for mining, rail, heavy industry and food and beverage applications, as well as any industry that uses large lubricant reservoirs.

How it works

Virtually maintenance free, the SKF Ultrasonic sensor utilizes ultrasonic waves to provide a non-contact measurement of the distance to the lubricant surface.

Depending on the preset window limits, a distance-proportional analog signal is output. The sensor's two-colour LED indicates operation and the status of the analog output.

Operational benefits:

- Reliable fill-level monitoring
- Easier maintenance
- Improved monitoring of pump function

Features:

- Reduced reservoir blind zones
- Analog output
- Continuous level message

Technical data

Technical data	Sensor	
Type	237-11204-7	237-11204-8
Operating range	0–500 mm (0–19.68 in.)	0–1 000 mm (0–39.37 in.)
Maximum operating height	600 mm (23.62 in.)	1 300 mm (51.18 in.)
Response time	272 ms	340 ms
Operating temperature	–40 to +70 °C (–40 to 158 °F)	
Protection class per EN 60529	IP67	
Type of connection	5-pin M12 circular plug, PBT	
Accuracy	+/- 1%	
Operating voltage	9–30 VDC	
Output type	4–20 mA or 0–10 V	
Lubricant	Oil and grease	
Reservoir capacities	bigger than 5 liter (1.321 US gal)	
Blind zones	10 mm (0.39 in)	

Accessories

Accessories	Order number
60, 90 & 120# FM II bucket level sensor adapter kit	279235
Straight M12 plug	237-13442-4
90 degree M12 plug	236-10022-6

Dimensional drawing

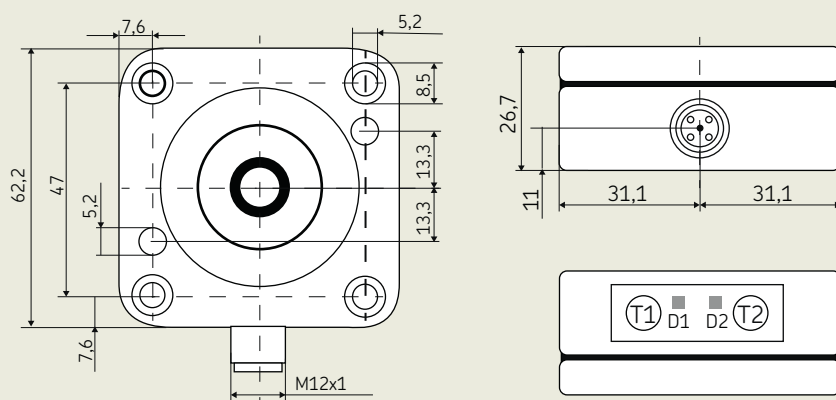

all measurements in mm

skf.com | skf.com/lubrication

© SKF is a registered trademark of the SKF Group.

© SKF Group 2016

The contents of this publication are the copyright of the publisher and may not be reproduced (even extracts) unless prior written permission is granted. Every care has been taken to ensure the accuracy of the information contained in this publication but no liability can be accepted for any loss or damage whether direct, indirect or consequential arising out of the use of the information contained herein.

PUB LS/P2.15603 EN · April 2016